

LineaCompact, Sliding door frame for stud walls

Included in scope of delivery:

- Sliding door frame LineaCompact with removable overhead track, mounted
- Accessory kit for wooden door leaves

To be supplied on site:

- Fastening material (dowels and screws)
- Solid padding
- Door leaf

Available as an option:

- Premium accessories
- Accessory kit for all-glass door leaves

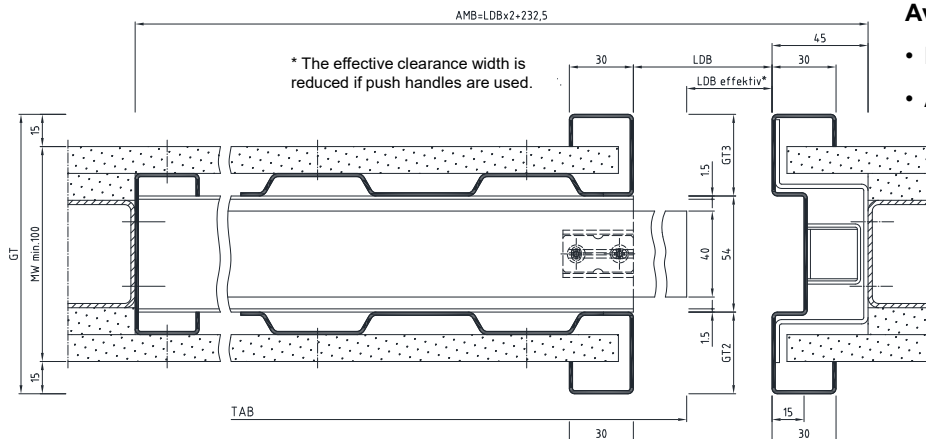

ISidW for stud walls

Please note: Read the installation instructions carefully before starting. Installation should be carried out by suitably trained personnel!

Before installation:

- Check that the frame conforms to the planning specifications of the client.
- Check the angularity of the frame.

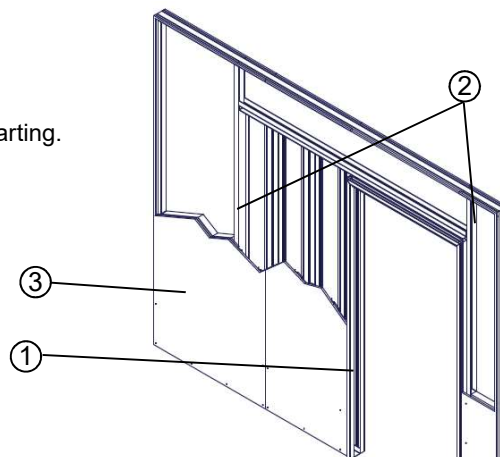

- (1) Sliding door frame LineaCompact
- (2) Stud wall (UA profiles)
- (3) Plasterboard panels
- (4) Entry profile
- (5) Bracket anchor
- (6) Transport profile
- (7) Track case
- (8) Floor profile
- (9) Stud wall closure profile
- (10) Removable inspection cover
- (11) Entry case profile
- (12) Guiding pin
- (13) Installation aid
- [14] For all-glass door leaves only:**
brush seal

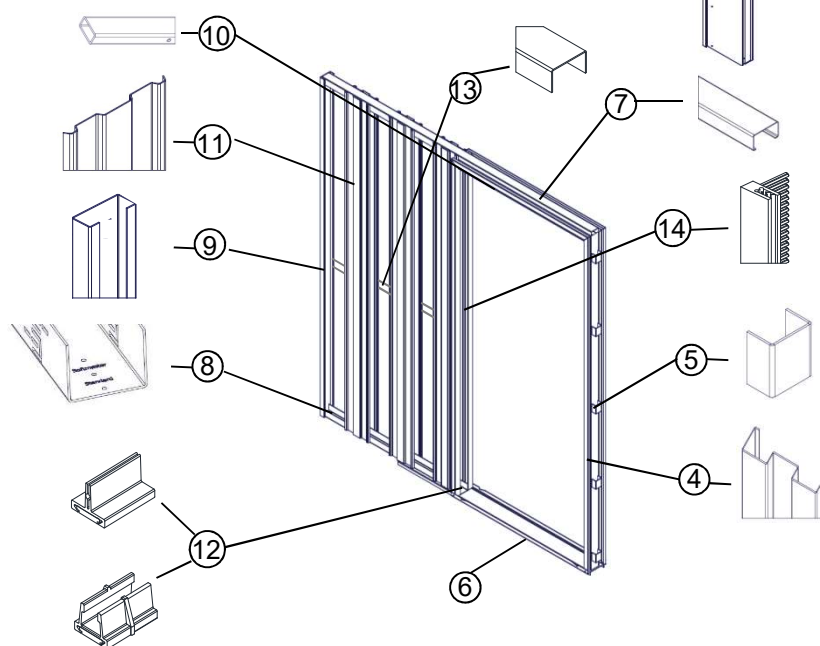

These installation instructions do not include static information.

Best Of Steel | 1

Sliding door leaf and operator

For professional installation of the sliding door leaf and drive system, please follow the respective installation instructions of the supplier.

Transport profiles

Transport profiles are a transport and installation aid which are fastened at the bottom of the steel frame to the side parts. They can be used as an installation aid for primed frames and should be removed directly after installation. With powder coated frames, the transport profiles must be removed before installation.

Transport profiles in
primed frames

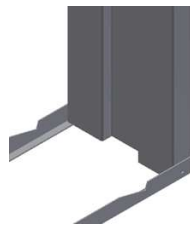

Transport profiles in
powder coated frames

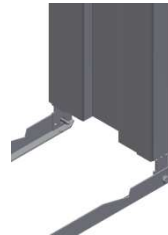

Please note:

The profile forms and measurements can differ from those illustrated in the installation instructions. Further installation tips can be found in the TTZ Installation Guidelines at www.BestOfSteel.de/en/tools-downloads.

If the frames are used in combination with fire and/or sound protection door leaves, the mounting parts and installation instructions from the authorisation holder must be followed!

The solid and stud walls or their profiles must be designed in such a way that they can reliably and permanently absorb the static and dynamic forces resulting from the load of the door element used.

Closing directions:

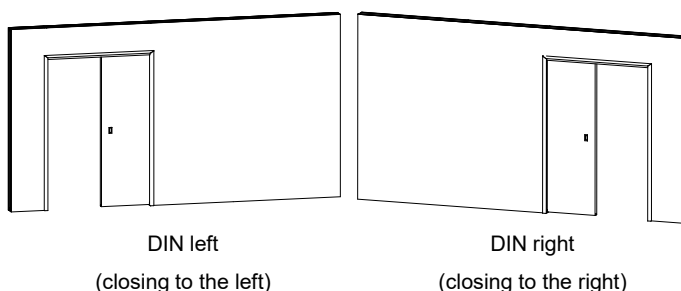

Detail metre mark:

Metre mark (MR) from
OFF = 1000mm

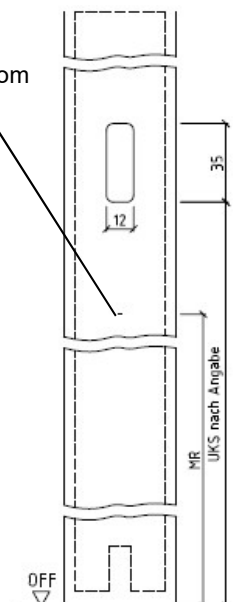

The transport packaging is disposed of by BOS Best Of Steel in cooperation with Zentek (within Germany).

Attention: The frame is delivered assembled!

Please take note of the transport profile information given on page 2 before installation!

1. Position the floor and ceiling profiles of the stud wall.

Remove the transport profile (6) from the bottom of the sliding door frame (1).

Position a vertical UA profile and align the sliding door frame LineaCompact (1) at the height of the metre mark (for metre mark explanation, see page 2).

Fasten the stud wall closure profile (9) to the UA profile securely (screws to be provided on site, set diagonally).

Important: Position the sliding door frame (1) centrally on the UA profile.

2. Position a vertical UA profile on the opposite side. Align the sliding door frame (1) vertically and horizontally using a spirit level and then fasten to the UA profile securely via the bracket anchors (5). Make sure that the clearance width (LDB) is upheld over the whole height of the frame.

3. Fasten the sliding door frame (1) via the floor profile (8) to the floor (OFF) using dowels and screws (not included).

4. Panel the sliding door frame (1) with plasterboard (3). The panelling of the entry case profile (11) should take place gently and not at the height of the installation aid (13). After panelling, the installation aid (13) should be removed.

Important: In order to avoid damage to the door leaf, the screws should not protrude into the entry area of the door under any circumstances.

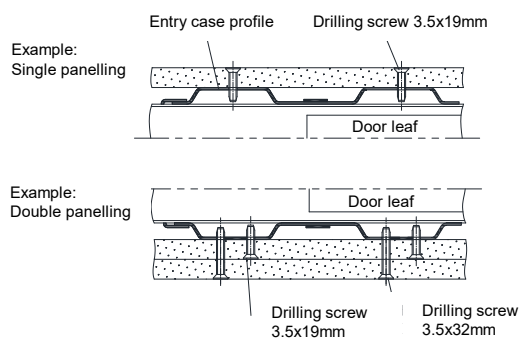

5. **Attention - for all-glass doors only:** Insert the brush seal [14] in the side part.

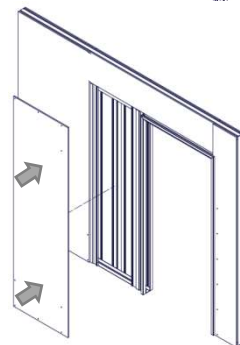
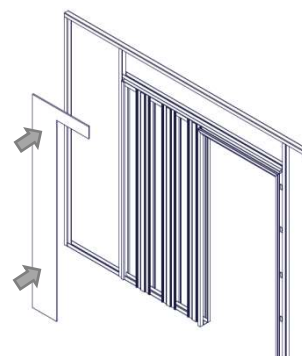
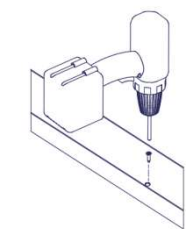
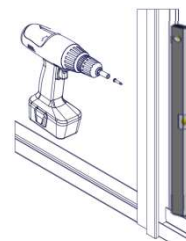
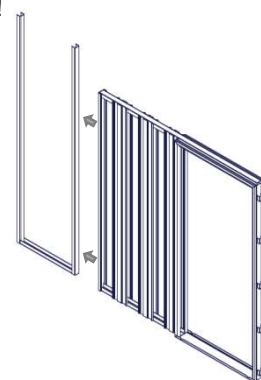
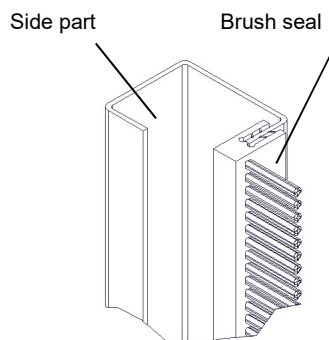
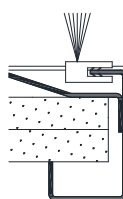

Mounting the door leaf

- 1) Remove the removable inspection tube (g).
- 2) Loosen the overhead track (a) via the screw on the closing side. Push the track towards the frame casing and remove.
- 3) Insert the fittings accessories e.g. carriage (b) and rail stops (c, d) into the overhead track (a) and position the back rail stop (c) (refer to the BOS rail stop positions in the fittings kit).
- 4) Now remount the overhead track (a) in the steel frame.
- 5) Mount the guiding pin (f) onto the plate provided on the floor profile.
- 6) Screw the bearing flanges (e) onto the sliding door leaf (refer to the BOS rail stop positions in the fittings kit).
- 7) Hang the bearing flanges (e) onto the carriage (b) and adjust the door leaf to the right height by turning the adjustment screws. The gap between the door leaf and the frame can be regulated by using the slotted holes of the bearing flanges (e).
- 8) Tighten the front rail stop (d) in the required position (refer to the BOS rail stop positions in the fittings kit).
- 9) Fasten the removable inspection tube (g) with the door open.

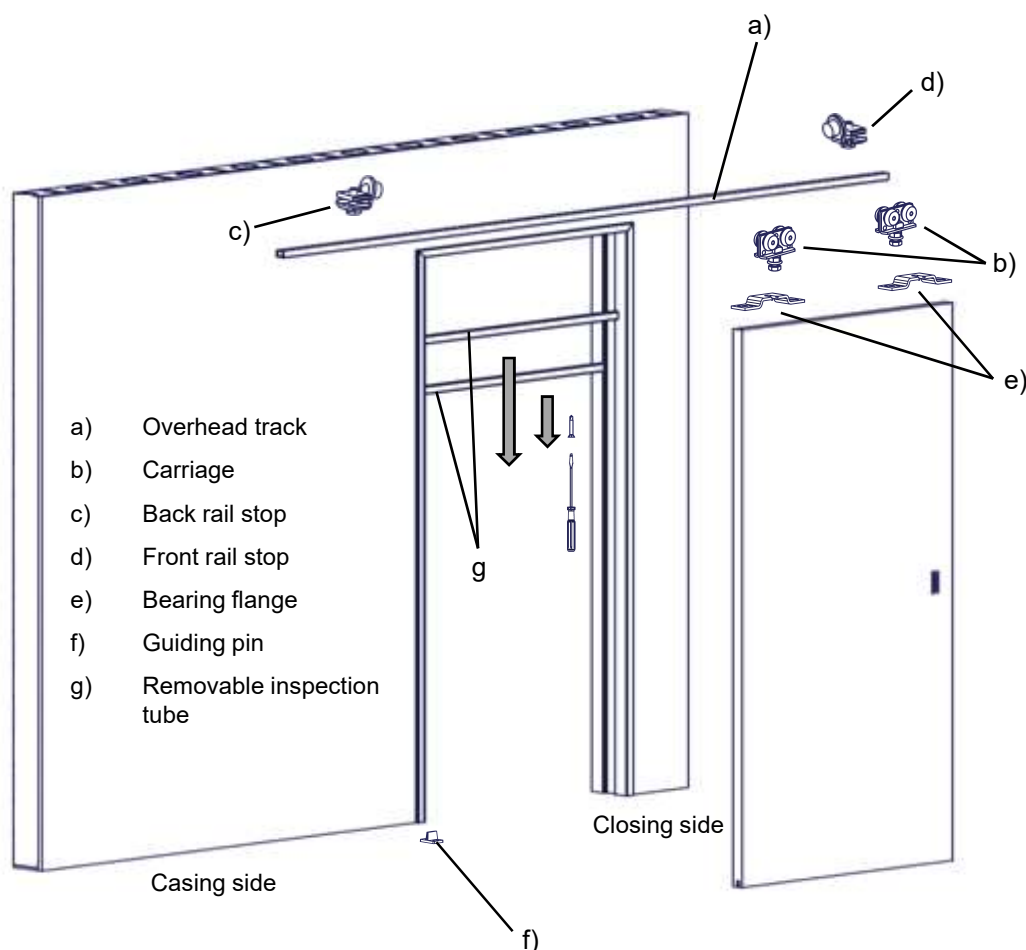

Maintenance Instructions

In order to ensure a proper functioning of the elements, a regular inspection and rectification of any defects identified is recommended.

Note: Detailed maintenance recommendations for the attachment parts can be obtained from the respective manufacturer. Special recommendations and regulations of the approval holders apply to fire and smoke protection doors.

Frame

- ✓ Check the frame is firmly secured in the wall.
- ✓ Check the frame, door fittings and the door leaf for mechanical damage and any possible corrosion damage.
- ✓ Depending on the design, check seals for damage, the correct seating in the frame and wear and tear. Any soiling on the seals can be removed using commercially available detergents.

Door leaf

- ✓ Check the grab handles, guiding pins of the door leaf, push handles and aluminium strip are secure.
- ✓ Check whether there is sufficient clearance (air gap) between the guiding pin and the groove.
- ✓ Depending on the design, the triggers of retractable seals should be checked for damage and functionality.

Attachment parts

- ✓ Check that the rail stops, catch stopers and guiding pins are securely in place, readjust if necessary and tighten the screws.
- ✓ Sliding door fittings require little maintenance and should not be oiled or greased.
- ✓ Check the fastenings of the bearing flanges to the carriages and the door. Tighten the screws if necessary.
- ✓ Check the carriages in the overhead track for smooth running, squeaking or grinding. Remove any soiling or foreign objects by suitable means.
- ✓ Depending on the design, the closure cushioning should be checked for function.
- ✓ Depending on the design, the automatic operator should be checked for function, in the event of improper operation an assessment should be carried out by trained personnel.

➤ **Stainless steel frames**

For the care of stainless steel frames, please follow the instructions on our website:
www.bestofsteel.de/en/tools-downloads