

Included in scope of delivery:

- Multi-part frame SolidFix^{by BOS} with adjustment area -5 to +15mm
- 5.2m elastic hollow chamber seal (separate)
- Levelling anchors with levelling screws and clamping anchors (mounted)
- Guiding anchors only for frames with receiving opening <125mm

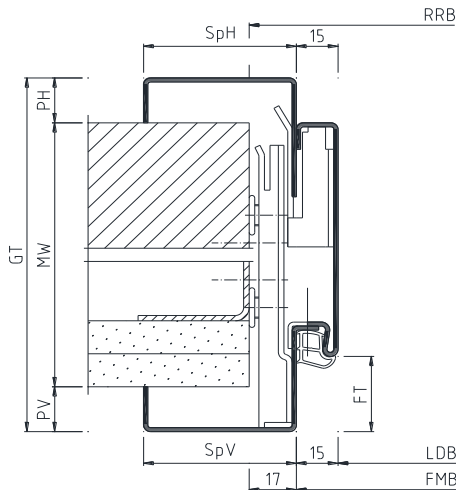

SolidFix^{by BOS} for stud / brick walls

To be supplied on site:

- Drilling screws for stud walls
- Screws and dowels for brick walls

- FMB = Frame rebate width
- FT = Rebate depth
- GT = Total profile depth
- LDB = Clearance width
- MW = Receiving opening
- OFF = Finished floor level
- PH = Back backbend
- PV = Front backbend
- RRB = Structural wall opening width
- SpH = Back architrave
- SpV = Front architrave

Please note: Read the installation instructions carefully before starting.

Installation should be carried out by suitably trained personnel!

Before installation:

- Check that the frame conforms to the planning specifications of the client.
- Check the angularity of the frame

- (1) Front part of frame
- (2) Middle section
- (3) Back part of frame
- (4) Drilling screw
- (5) Levelling anchor
- (6) Clamping anchor
- (7) Levelling screw (2 per anchor)
- (8) Drilling screws for stud walls, screws with dowels for brick walls (2 per anchor, to be supplied on site)
- (9) Wall / Supporting structure
- (10) Elastic hollow chamber seal

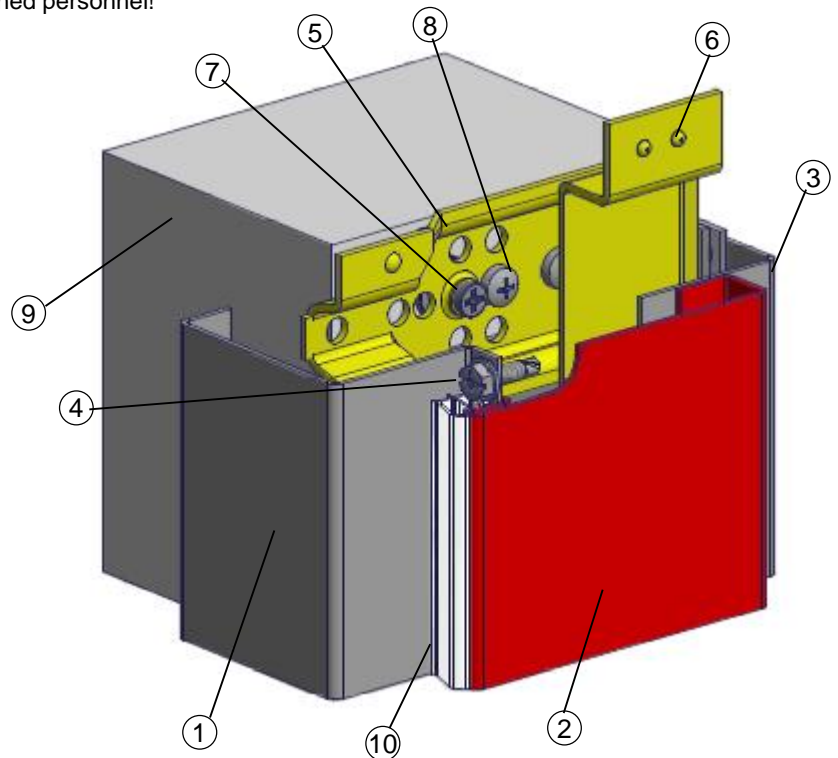

Seals

Do not use nitro-based paint. Cut the seal for the headpiece to length without stretching and without a mitre. Then push the seal into the correct position in the profile. Repeat for the side parts. Clean dirty seals carefully using washing-up liquid.

Permanently elastic acrylic joint

In order to prevent cracking, joints with a width of 5-8mm should be formed.

Spacer rails

Spacer rails are transportation aids, which are fastened at the bottom of the steel frame to the side parts. In primed frames they can be used as an installation aid and then removed directly after installation. In powder coated frames the spacer rails must be removed before installation.

Spacer rail of a primed frame

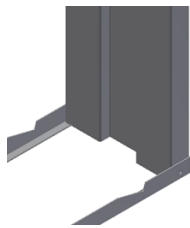

Spacer rail of a powder coated frame

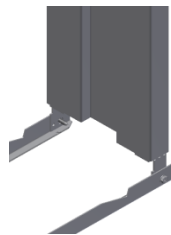

Transportation guard of all frames

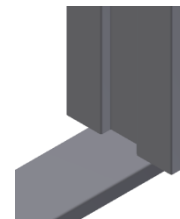

Please note:

The profile forms and the measurements can differ from those illustrated in the installation instructions. Further installation instructions can be found in the TTZ installation guidelines at www.BestOfSteel.de/en/tools-downloads/.

If the frames are used in combination with fire or sound protection doors, the installation and fittings instructions of the authorisation owner must be followed!

The solid and/or stud walls and their profiles must be constructed in such a way that they can reliably and sustainably withstand the static and dynamic forces resulting from the loads of the door elements used.

Detail metre mark:

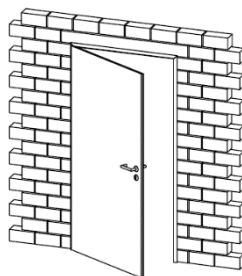

View DIN left



View DIN right

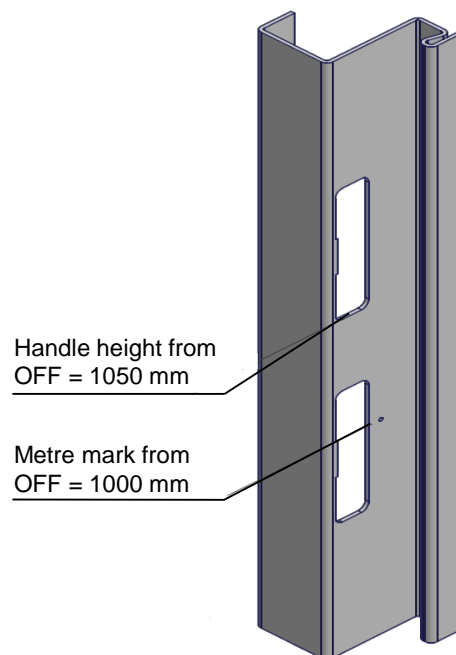

Attention: Please take note of the spacer rail information given on page 2 before installation!

1. The frame is delivered pre-assembled. Remove the back part of frame (3). Remove the drilling screws (4) connecting the front (1) and middle section (2) of the frame using a cross tip screwdriver and pull the two frame parts apart.

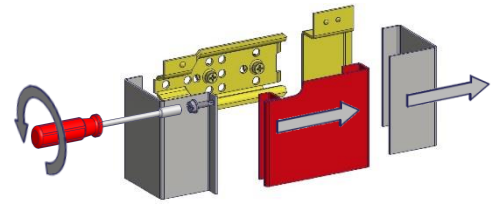

2. Insert the front part of the frame (1) into the wall opening and align according to the metre mark. If necessary, enlarge the opening for the mortar protection cover and the hinge pockets (see page 2 for metre mark explanation).

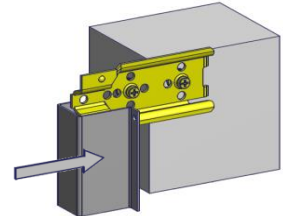

3. Align the front part of the frame (1) horizontally and in the perpendicular using the levelling screws (7) and a spirit level.

Important: At least two threads of the levelling screws (7) must grip the levelling anchor.

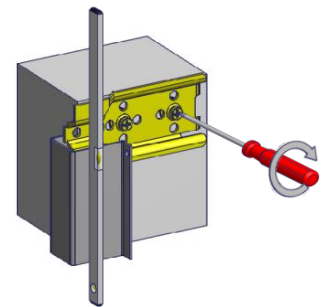

4a. Stud walls:

Join the aligned front part of the frame (1) to the stud wall support by inserting the drilling screws (4) through the holes provided in the levelling anchor (5) (2 screws per anchor).

4b. Brick walls:

Mark the position for drilling the holes for fastening the levelling anchors (5) to the wall (9). Drill the holes where marked then use dowels and screws (8) to connect the frame to the brick wall.

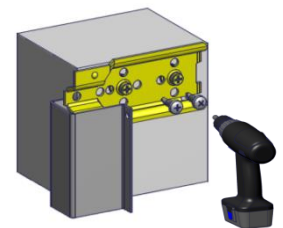

- 5a. The adjustable guiding anchors (11) are only used with a receiving opening of <125mm and are positioned under the lower levelling anchors (5).

Stud walls:

Connect the guiding anchor (11) to the UA profile through the given holes using drilling screws (2 screws per anchor, supplied by customer).

Brick walls:

Place the guiding anchor (11) on the wall (9), mark the position of the pre-punched holes on the wall and then drill the holes (Attention: Observe edge distances). Fasten the guiding anchors to the brick wall using dowels and screws (at least 2 screws per anchor set diagonally, supplied by customer).

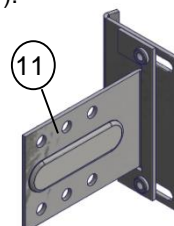
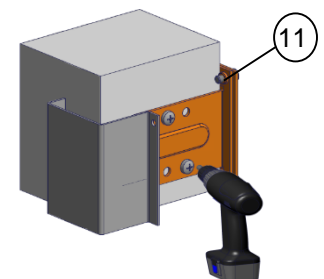

5b. The moveable part of the guiding anchor (11) can be adjusted as necessary with the help of the adjustment screw (12).

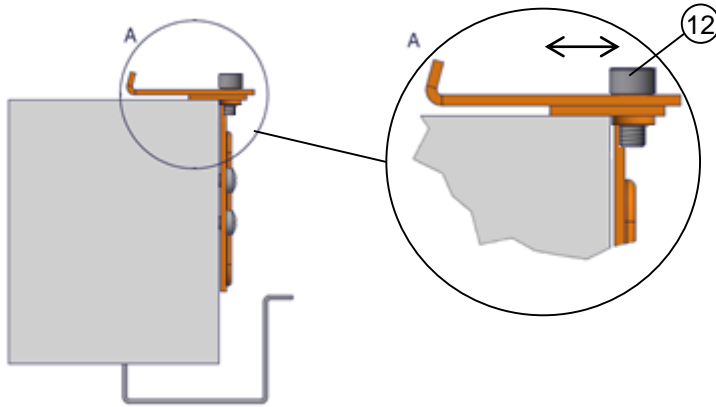

6. Push the middle section (2) into position. Connect the two frame parts in the rebate with the drilling screws (4).

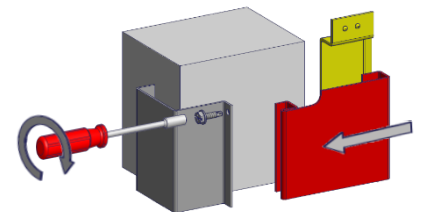

7. Push the back part of the frame (3) into position.

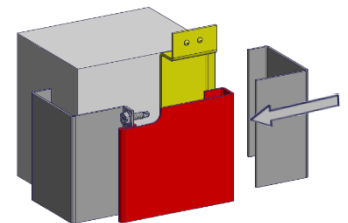

8. Once the paint is dry, insert the elastic hollow chamber seal (10), thus covering the drilling screws (4) in the rebate. When installing the hinges, follow the instructions given on the seal packaging.

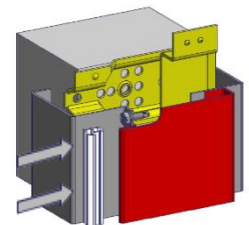

Maintenance Instructions

In order to ensure a proper functioning of the frame, a regular inspection and rectification of any defects identified is recommended.

General condition: Please check the frame and the door leaf for any mechanical or corrosion damage. These types of damage must be rectified!

Seals

These are to be checked for damage, a proper fit and wear. Damaged seals should be replaced. Dirt on the seals can be removed using commercial detergent.

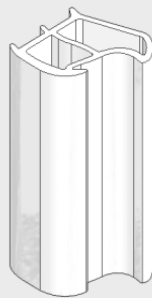

Elastic hollow chamber seal

Hinge pockets

Please control the fastening of the hinges and tighten the screws if necessary. Replace worn parts.

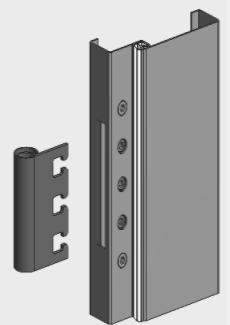

VX hinge pocket with 3 clamping screws and 2 adjustment screws

Latch/Bolt cut-out

Please check the area of the latch/bolt cut-out for defects. Any damages should be correctly repaired.

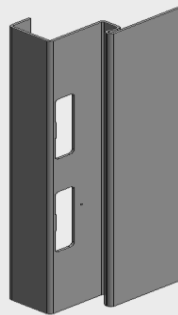

Latch/Bolt cut-out

Attachments

Please check the fastenings of all attachment parts (striking plates, door closers etc.) and tighten the screws where necessary. Damaged parts should be replaced.

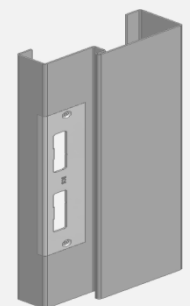

Striking plate

Stainless steel frames

For the care of stainless steel frames please refer to our instructions:
<https://www.bestofsteel.de/en/tools-downloads/care-and-maintenance-instructions/>