

Included in scope of delivery:

- Corner frame with corner frame nail anchors
- 5.2m elastic hollow chamber seal (separate)
- Fastening for the metre joint

To be supplied by the customer:

- Fastening for the corner frame nail anchors
- Solid padding (i.e. hardwood, plastic, steel, plaster blocks) if applicable

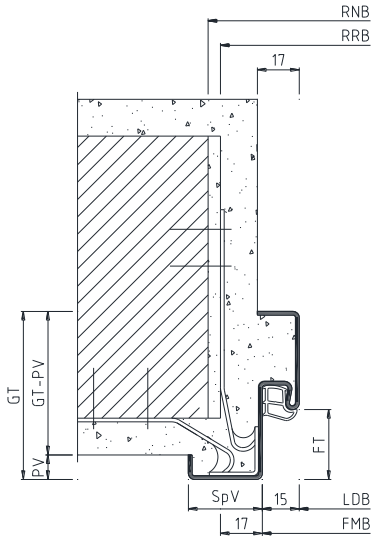

- FMB = Frame rebate width
- FT = Rebate depth
- GT = Total profile depth
- LDB = Clearance width
- MW = Receiving opening
- OFF = Finished floor level
- PV = Front backbend
- RRB = Structural wall opening width
- SpV = Front architrave

Eud / Esd for brick walls

Please note: Read the installation instructions carefully before starting.
Installation should be carried out by suitably trained personnel!

Before installation:

- Check that the frame conforms to the planning specifications of the client.
- Check the angularity of the frame.

- (1) Corner frame
- (2) Brick wall
- (3) Plaster
- (4) Corner frame nail anchor
- (5) Fastening for the corner frame nail anchor (in this case screws)
- (6) Elastic hollow chamber seal
- (7) Metre joint (see site 2)
- (8) Fastening for the metre joint (see site 2)

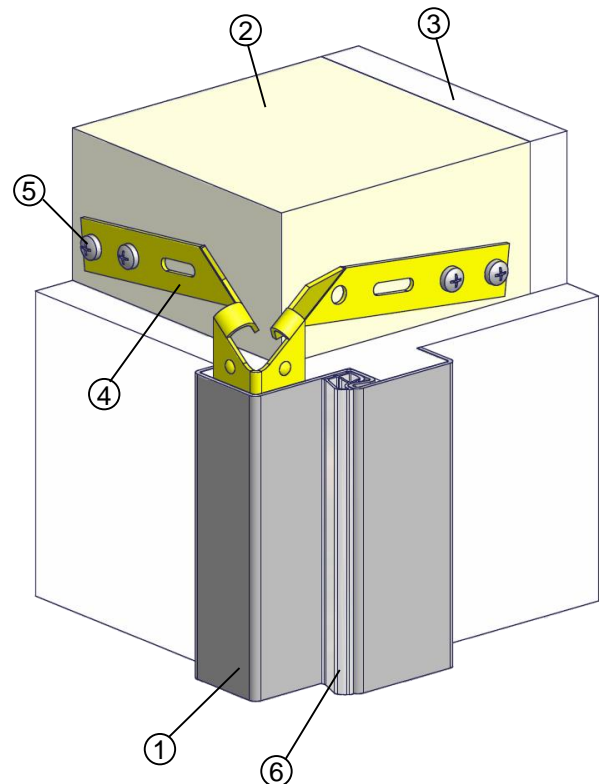

Seals

Do not use nitro-based paint. Cut the seal for the headpiece to length without stretching and without a mitre. Then push the seal into the correct position in the profile. Repeat for the side parts.

Spacer rails

Spacer rails are transportation and installation aids, which are fastened at the bottom of the steel frame to the side parts. The spacer rails can be used as an installation aid in primed frames and should be removed afterwards. The spacer rails in powder coated frames must be removed before installation.

Spacer rail in a primed frame

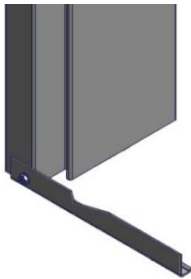

Spacer rail in a powder coated frame

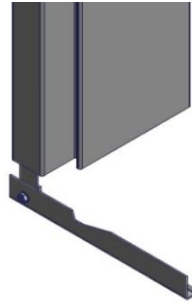

Please note:

The profile forms and measurements can differ from those illustrated in the installation instructions. Further installation tips can be found in the TTZ installation guidelines at www.BestOfSteel.de.

If the frames are used in combination with fire or sound protection door leaves, the mounting parts and installation instructions from the authorisation holder must be followed!

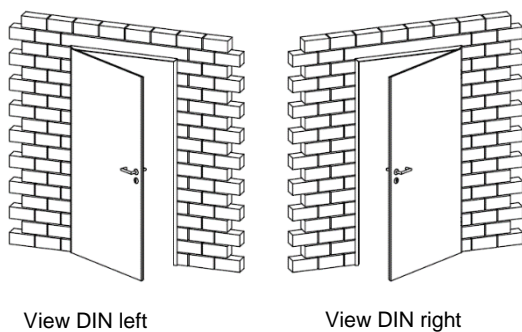

Detail metre mark:

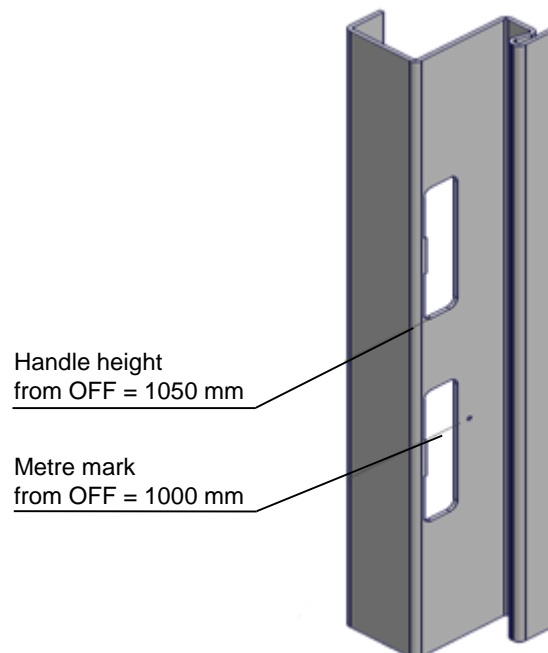

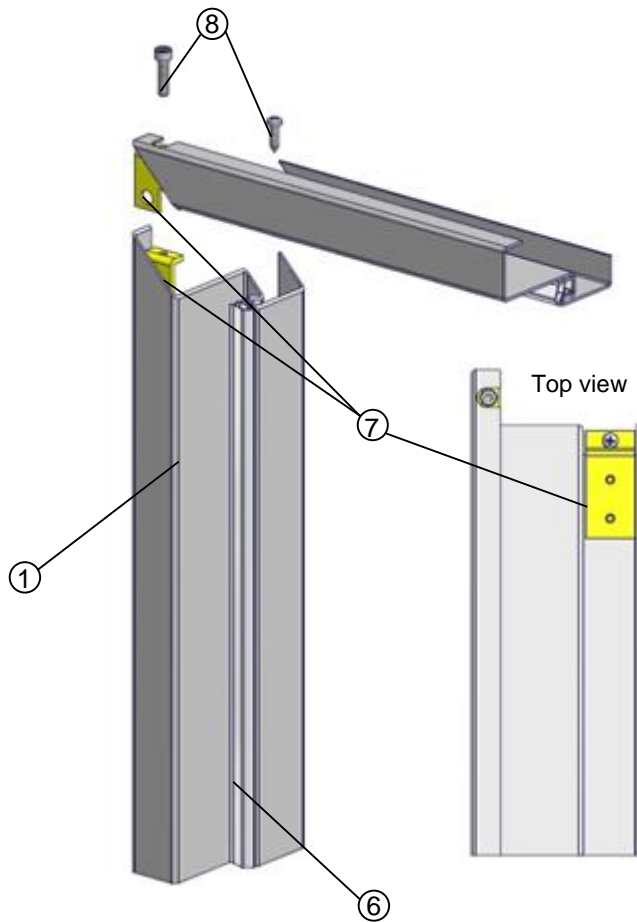

1. Place the frame element on a level floor.
2. Push the side parts and the headpiece into each other
3. Fasten the mitre joint (7) with the supplied screws (8).

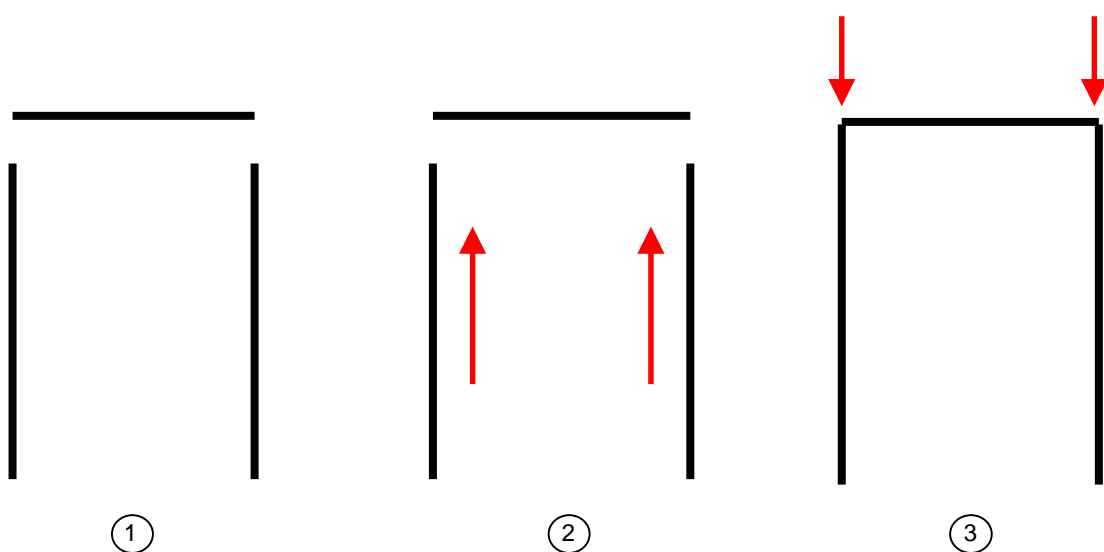

These installation instructions do not include static information.

Best Of Steel | 3

1. Unfold the corner frame nail anchors (4).

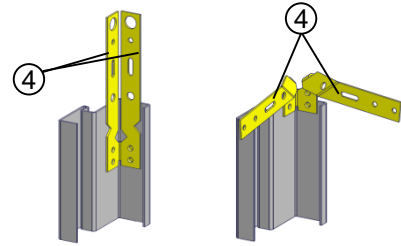

- 1.1 Push the corner frame (1) into the wall opening and align in height according to the metre mark. (For metre mark explanation see page 3.)

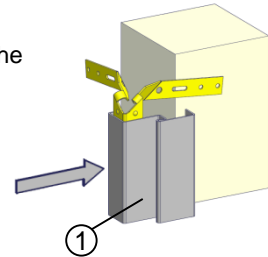

2. Align the corner frame (1) vertically and diagonally with a spirit level and screw the corner frame nail anchors (4) to the brick wall (2). Push the slightly inwardly curved frame apart and with the aid of the spacer board, ensure that the rebate width measurement is upheld over the total height of the frame.

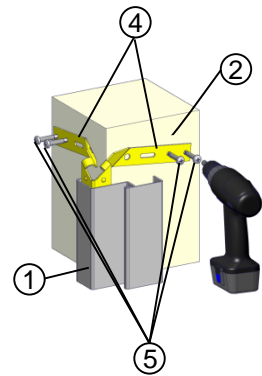

3. Backfill the frame with moist standard mortar (approx 1:4 according to DIN 1053-1). Once the backfilling is dry, remove the spacer boards and spacer rails (at the bottom of the frame) and plaster the wall.

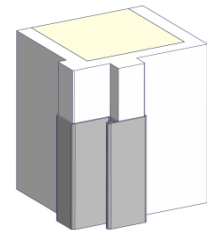

4. Once the paint on the frame is dry, the elastic hollow chamber seal (6) can be inserted. When installing the hinges, follow the instructions on the seal packaging.

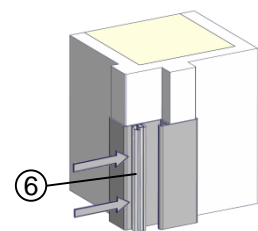

Maintenance Instructions

In order to ensure a proper functioning of the frame, a regular inspection and rectification of any defects identified is recommended.

General condition: Please check the frame and the door leaf for any mechanical or corrosion damage. These types of damage must be rectified!

Seals

These are to be checked for damage, a proper fit and wear. Damaged seals should be replaced. Dirt on the seals can be removed using commercial detergent.

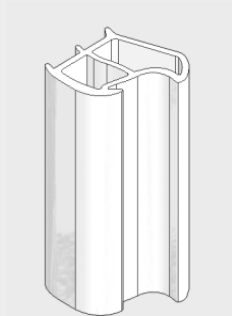

Elastic hollow chamber seal

Hinge pockets

Please control the fastening of the hinges and tighten the screws if necessary. Replace worn parts.

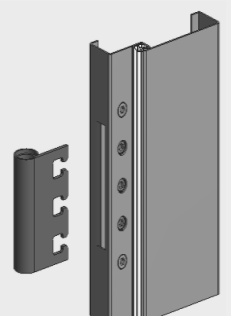

VX hinge pocket with 3 clamping screws and 2 adjustment screws

Latch/Bolt cut-out

Please check the area of the latch/bolt cut-out for defects. Any damages should be correctly repaired.

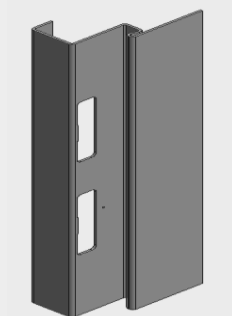

Latch/Bolt cut-out

Attachments

Please check the fastenings of all attachment parts (striking plates, door closers etc.) and tighten the screws where necessary. Damaged parts should be replaced.

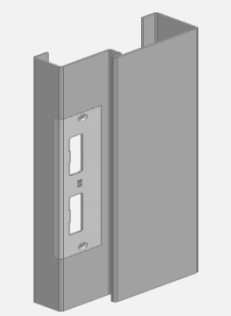

Striking plate

Stainless steel frames

For the care of stainless steel frames please refer to our instructions.
<https://www.bestofsteel.de/en/tools-downloads/care-and-maintenance-instructions/>